

# DELAWARE TECHNICAL COMMUNITY COLLEGE

## GUIDE TO GETTING AROUND THE JACK F. OWENS CAMPUS

### LOCATION

- Jason Technology Center
- Campus Store
- Energy House
- Arts & Science Center
- Stephen J. Betze Library
- Carter Partnership Center
- Trade & Industry Building
- Environmental Training Center
- Child Development Center
- Student Services Center

### KEY

- 1
- 1A
- 2
- 3
- 4
- 5
- 6
- 7
- 8
- 9

### ROOMS

- 001-199
- 200 Series
- 300 Series
- 400 Series
- 500 Series
- 600 Series
- 700 Series
- 800 Series
- 900 Series

### LOCATION

- Campus Dining
- Agriculture Education Building
- Production Agriculture Education Building
- Facilities/Shipping & Receiving Building
- Employee Parking
- Turf Grass Lab
- Environmental Training Lab

### KEY

- 9A
- 10
- 11
- 12
- 13
- 14
- 15

### ROOMS

- 1100 Series
- 1700 Series

### SYMBOL KEY

- Walkways
- Covered Walk
- Bridge
- Public Safety Information
- First Aid Kit
- Dart Bus Stop

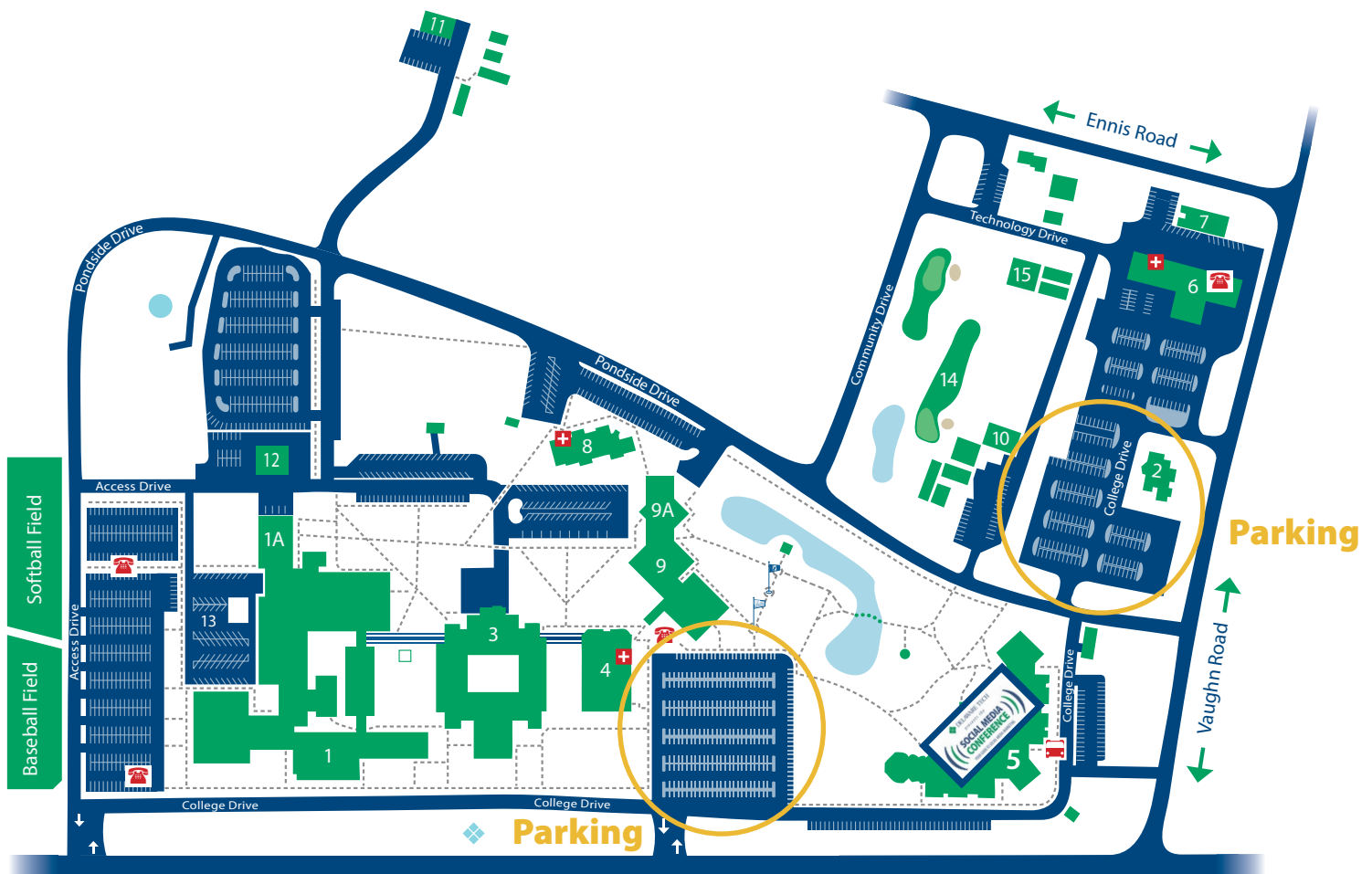

← To Route 113 North/South

**Main Entrance**

← Seashore Highway, Route 18/404 →

Mailing address: 21179 College Drive, Georgetown, Delaware 19947 • For driving directions visit: [www.dtcc.edu/our-campuses/georgetown/directions](http://www.dtcc.edu/our-campuses/georgetown/directions)

# WILLIAM A. CARTER PARTNERSHIP CENTER



- Conference
- Breakout Sessions
- Lunch and Refreshments
- Check-In

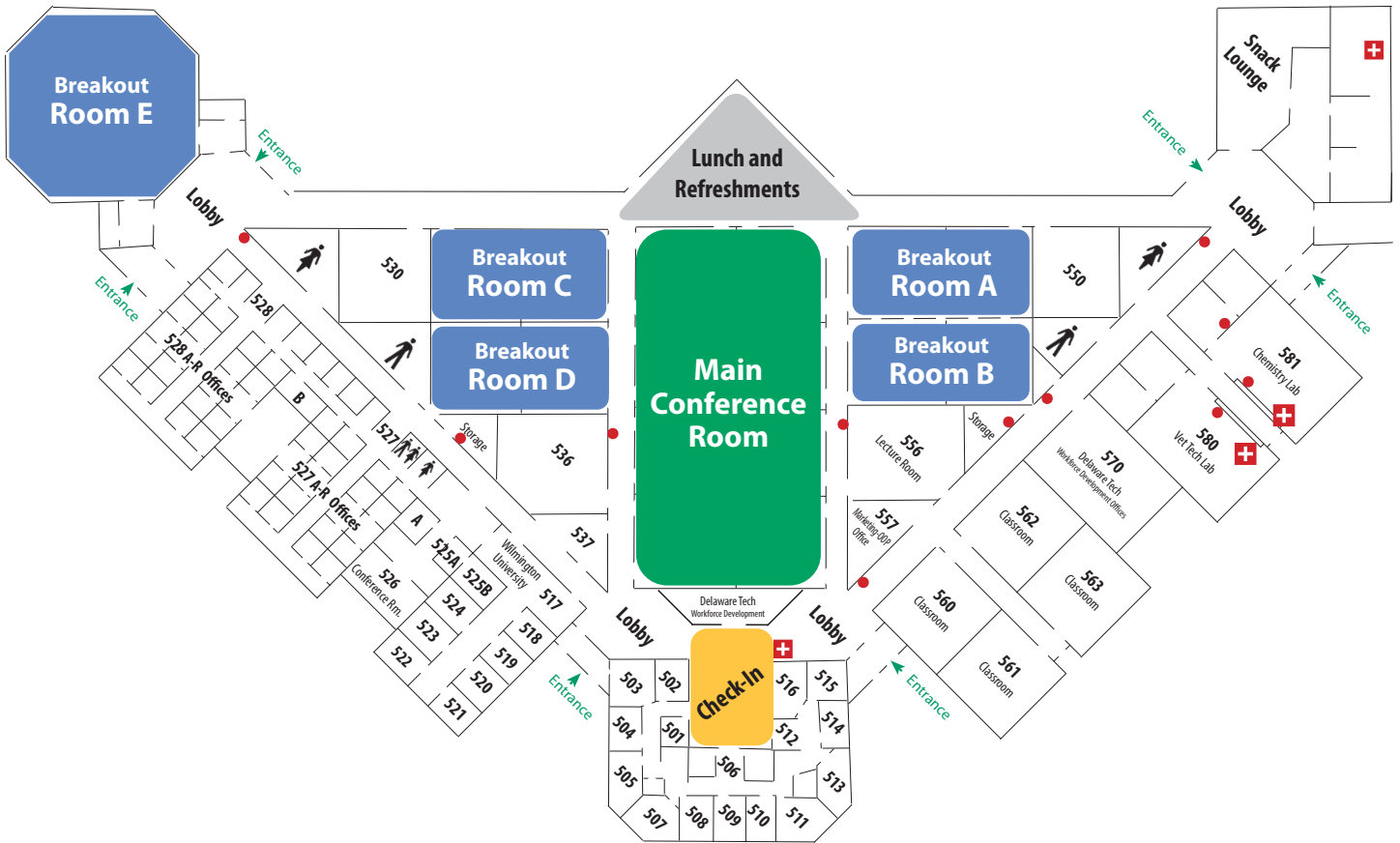

**WILLIAM A. CARTER PARTNERSHIP CENTER**

- Delaware State University
- Faucett Lecture Hall
- Ponside Lounge
- Snack Lounge
- University of Delaware
- Wilmington University
- Workforce Development and Community Education

-  /delawaretech
  -  /dtccvideo
  -  /delaware\_tech
  -  /delawaretech
  -  /school/delawaretech
- [www.dtcc.edu](http://www.dtcc.edu)